



Description

The SQV40 is three-piece ball valve with Quarter-turn function having Stainless Steel material and PTFE sealing gasket. This valve has been designed to meet the following standards:
Design standard: ASME B16.34
Test & Inspection: API598, EN12266

Fluids handled

Steam
Condensate
Compressed air/Inert gas
Water services
Liquid and gaseous systems

Sizes and connections

Screwed - BSP1/2" to 2"

Dimensions and weights (mm and kg)

Size (DN).	L	H	L1	D	Weight
15	133	80	75	28	0.40
20	149	85	80	35	0.61
25	152	97	90	43	0.70
32	173	110	110	57	0.95
40	210	121	120	60	1.30
50	241	143	140	74	2.45

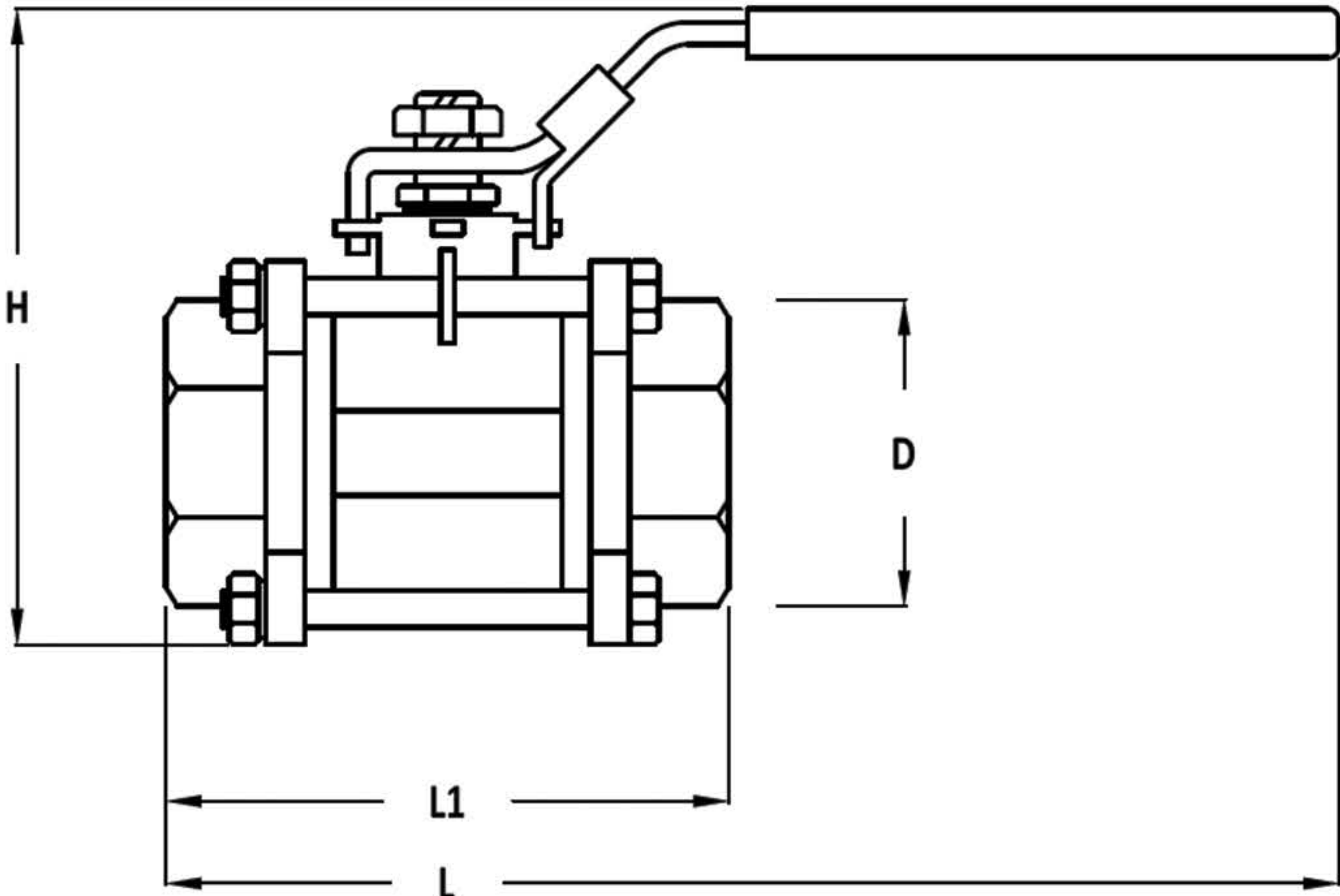

Safety information, installation and maintenance

The SQV40 ball valves are applicable for on/off applications. It is not recommended to apply ball valves for modular control of fluid flows.

*For full details see the Installation and Maintenance Instructions, supplied with the product.

Limiting Conditions

Body design conditions	1000 PSI (1000 WOG)
Maximum allowable pressure (PMA)	63 bar g @ 100 °C
Maximum allowable temperature (TMA)	180 °C @ 12 bar g
Maximum operating pressure (PMO)	40 bar g
Maximum operating temperature (TMO)	180 °C
Cold hydraulic test pressure	95 bar g

Materials

NO.	Part	Material	
1	Body	Stainless Steel A-351CF8	304
2	Ball	Stainless Steel	304
3	Ball Seat	PTFE	-
4	Thrust Washer	PTFE	-
5	Body Gasket	PTFE	-
6	Body Gasket	PTFE	-
7	Stem Packing	Stainless Steel	304
8	Gland Nut	Stainless Steel	304
9	Stem	Stainless Steel	304
10	Spring Washer	Stainless Steel	304
11	Nut	Stainless Steel	304
12	Handle	Stainless Steel	304
13	Handle Lock	Plastic	-
14	Handle Cover	Stainless Steel A-351CF8	304
15	Cap	Stainless Steel	304
16	Spring Washer	Stainless Steel	304
17	Bolt	Stainless Steel	304

