



Description

The SST10 is Strainer with Screwed Ends in Stainless Steel body construction, which arrest solids in flowing liquids or gases, and protect equipment from their harmful effects, thus reducing downtime and maintenance. A strainer should be fitted upstream of every steam trap, flowmeter and control valve.

Fluids handled

- Water services
- Saturated steam
- Thermal oil
- Non-aggressive liquids & gases

Sizes and connections

Screwed-BSP

1/2" to 2"

Dimensions and weights (mm and kg)

Size (DN)	H	L	D	Weight
15	51	60	25	0.15
20	63	71	30	0.20
25	75	83	37	0.30
32	87	96	46	0.50
40	99	106	53	0.70
50	121	123	64	1.00

*Screen mesh size is available in different width as requested.

Limiting Conditions

Body design conditions	PN16
Maximum allowable pressure (PMA)	16 bar g @ 120 °C
Maximum allowable temperature (TMA)	180 °C @ 13 bar g
Maximum operating pressure (PMO)	13 bar g
Maximum operating temperature (TMO)	180 °C
Cold hydraulic test pressure	24 bar g

Materials

NO.	Part	Material	
1	Body	Stainless Steel	304
2	Cap	Stainless Steel	304
3	Gasket	Graphite	-
4	Screen	Stainless Steel	304

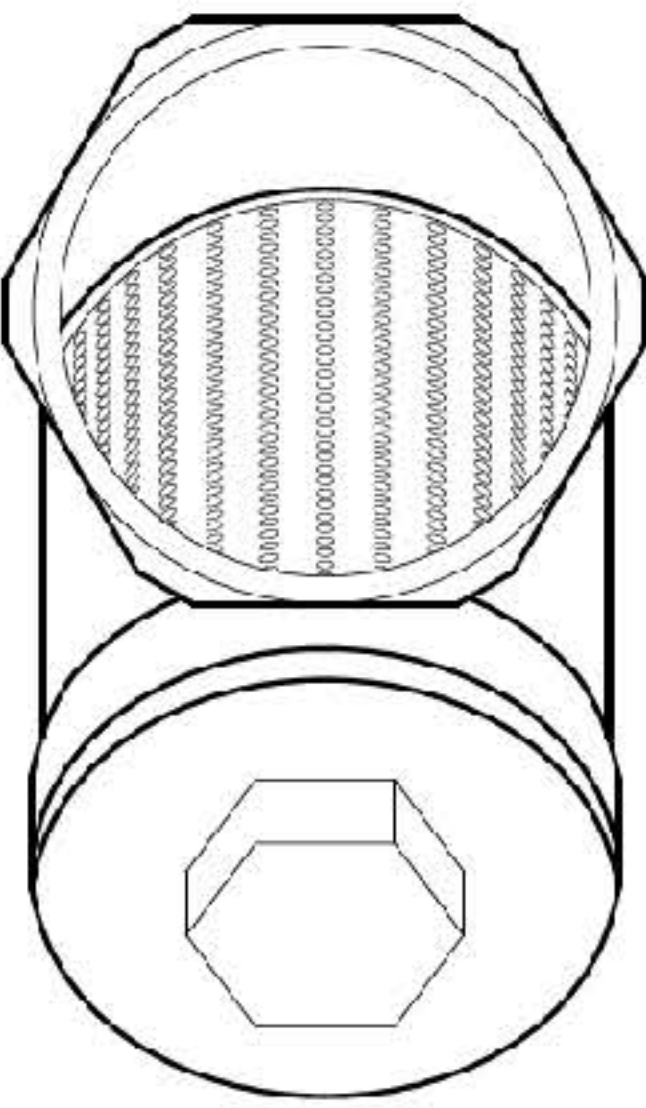
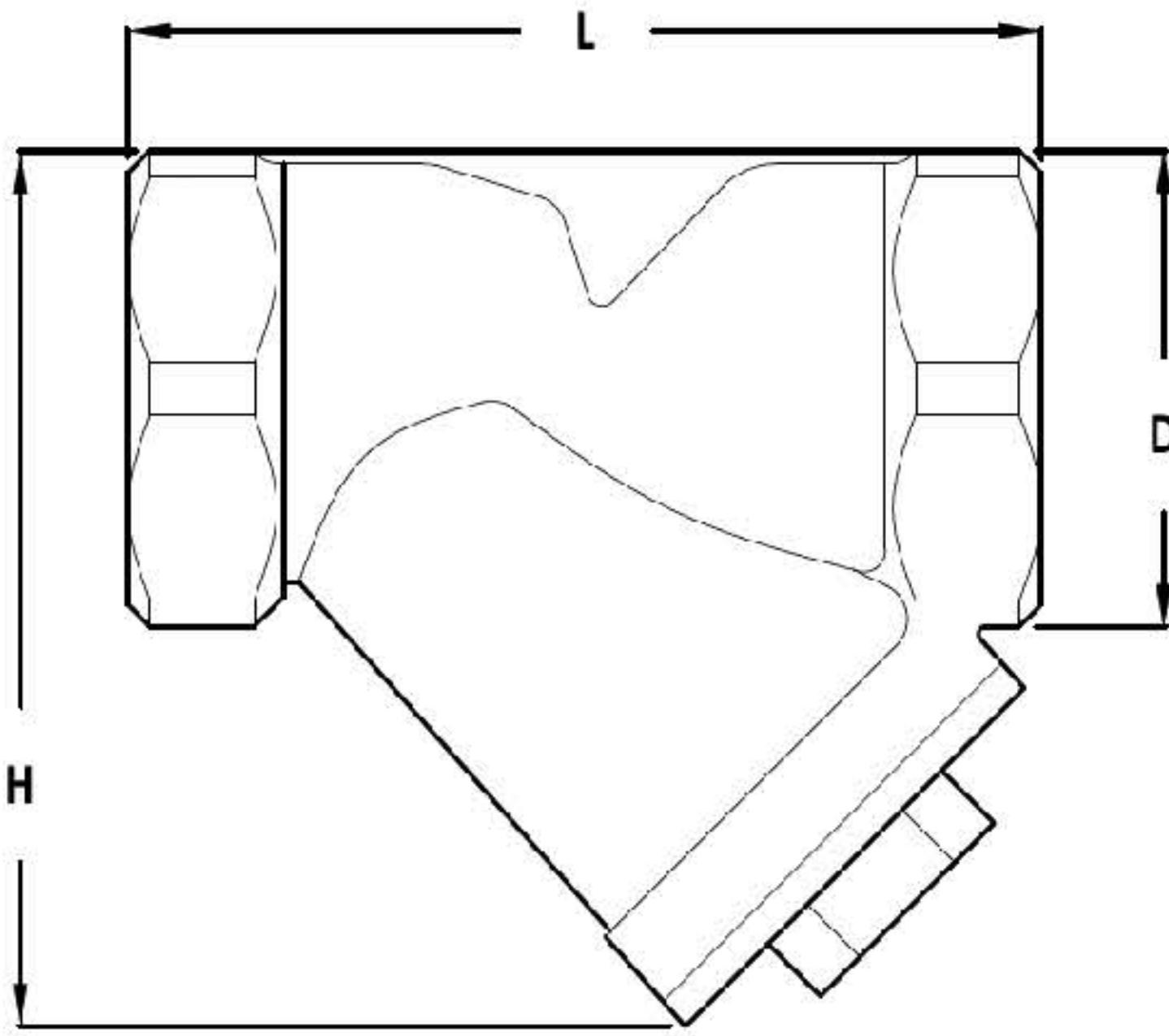
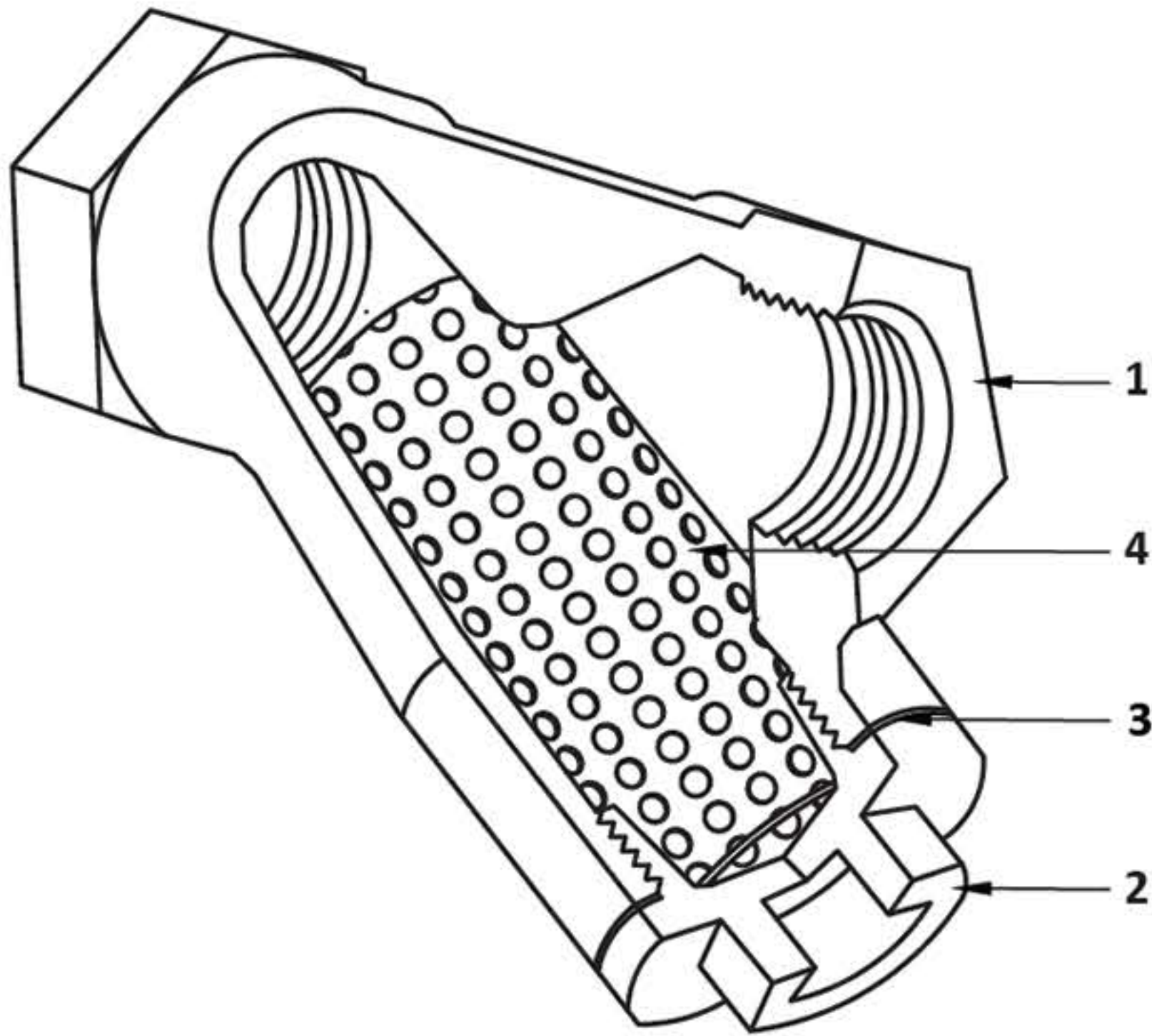

Safety information, installation and maintenance

The SST25 must be installed with the direction of flow as indicated on the body. On applications, involving steam or gas, the pocket should be in the horizontal plane. On liquid systems, the pocket should point downward.

*For full details see the Installation and Maintenance Instructions, supplied with the product.